

W 1/4 COR. SEC. 29
FROM THE SOUTH
2" AC LS 12061

OWNER
PILOT TRAVEL CENTERS LLC, A DE LLC
ATTN: PROP TAX DEPT/308

OWNER
MILLIKEN RENTALS LLC
S89°51'23"E 264.90'(C)
N88°36'00"W 270.80'(R)

LYON STREET (60' ROW)

S89°51'23"E 235.13'(C)
N88°36'00"W 240.80'(R)

LOT 1, BLOCK 1
McCUE ADDITION
FND 1.5" AC ON
REBAR, ILLEGIBLE

235.52'(C)
240.80'(R)

LOT 2, BLOCK 1
McCUE ADDITION

235.91'(C)
240.80'(R)

OWNER
A J HOSPITALITY, INC
ATTN: A J KONCZEWSKI
LOT 3, BLOCK 1
McCUE ADDITION

236.29'(C)
240.80'(R)

LOT 4, BLOCK 1
McCUE ADDITION

236.68'(C)
240.80'(R)

LOT 5, BLOCK 1
McCUE ADDITION

237.07'(C)
240.80'(R)

LOT 6, BLOCK 1
McCUE ADDITION

237.46'(C)
240.80'(R)

LOT 7, BLOCK 1
McCUE ADDITION

237.84'(C)
240.80'(R)

LOT 8, BLOCK 1
McCUE ADDITION

238.23'(C)
240.80'(R)

LOT 9, BLOCK 1
McCUE ADDITION

238.62'(C)
240.80'(R)

LOT 10, BLOCK 1
McCUE ADDITION

239.01'(C)
240.80'(R)

LOT 11, BLOCK 1
McCUE ADDITION

S89°56'34"W 239.45'(C)
N88°36'00"W 240.80'(R)

BAKER STREET (60' ROW)

OWNER
SUNNY MEADOWS VILLAGE COMMUNITY LP
ATTN: DORIS L BURN-MANFELL

OWNER
BHARAT D CHAUDHARI LIVING TRUST

OWNER
SAMUEL J & ZACHERY J DEBERARD

OWNER
JEHOVAHS WITNESSES LARAMIE, WY INC,
A NON PROFIT CORP

OWNER
THE TIMBERS LLC, A WY LLC
ATTN: JOHN P MURPHY



VICINITY MAP
SCALE: 1"=500'

VACATION DESCRIPTION

A 30-FOOT ALLEY LOCATED IN THE SOUTHWEST QUARTER OF SECTION 29, TOWNSHIP 16 NORTH, RANGE 73 WEST OF THE 6TH P.M. BEING MORE PARTICULARLY DESCRIBED AS FOLLOWS:

COMMENCING AT THE SOUTHWEST CORNER OF SAID SECTION 29 BEING A 3.25" ALUMINUM CAP STAMPED PE/LS 4822 FOUND;

THENCE NORTH 55°28'03" EAST 1632.47 FEET TO THE SOUTHWEST CORNER OF SAID 30-FOOT ALLEY DESCRIBED IN RECEPTION NO. 801974 RECORDED AT THE ALBANY COUNTY CLERK AND RECORDS OFFICE, BEING A #5 REBAR AND 2" ALUMINUM CAP STAMPED PE/LS 9239 SET, AND THE POINT OF BEGINNING OF THIS VACATION DESCRIPTION;

THENCE NORTH 00°12'48" EAST 1126.36 FEET TO THE NORTHWEST CORNER OF SAID 30-FOOT ALLEY AND A #5 REBAR AND 2" ALUMINUM CAP STAMPED PE/LS 9239 SET;

THENCE SOUTH 89°51'23" EAST 30.00 FEET TO THE NORTHEAST CORNER OF SAID 30-FOOT ALLEY AND A 1.5" ALUMINUM CAP ILLEGIBLE;

THENCE SOUTH 00°12'48" WEST 1126.25 FEET TO THE SOUTHEAST CORNER OF SAID 30-FOOT ALLEY AND A #5 REBAR AND 2" ALUMINUM CAP STAMPED PE/LS 9239 SET;

THENCE SOUTH 89°56'34" WEST 30.00 FEET AND THE POINT OF BEGINNING.

SAID PARCEL CONTAINS 33789 SF (0.78 ACRES), MORE OR LESS, AND IS SUBJECT TO ALL RIGHTS-OF-WAY, EASEMENTS AND RESTRICTIONS OF RECORD.

LINE #	BEARING	LENGTH
L1	S89°51'23"E	30.00'
L2	S89°56'34"W	30.00'

LEGEND:

- FOUND SECTION MONUMENT - AS DESCRIBED
- FOUND MONUMENT - AS DESCRIBED
- SET #5 REBAR & 2" ALUM. CAP, PE/LS 9329, OR AS SHOWN
- (R) RECORD INFORMATION
- (C) CALCULATED INFORMATION
- (M) MEASURED INFORMATION
- ROW RIGHT-OF-WAY
- AC ALUMINUM CAP
- REV. REVISED
- P.O.B. POINT OF BEGINNING

Attachment A

STATEMENT OF SURVEYOR:

I, DAVID R. COFFEY, A REGISTERED PROFESSIONAL ENGINEER AND LAND SURVEYOR IN THE STATE OF WYOMING, HEREBY STATE, THAT THIS MAP WAS PREPARED FROM FIELD NOTES TAKEN DURING AN ACTUAL SURVEY, MADE UNDER MY DIRECT SUPERVISION, AND THAT THIS MAP CORRECTLY SHOWS THE RESULTS OF SAID SURVEY, TO THE BEST OF MY KNOWLEDGE.

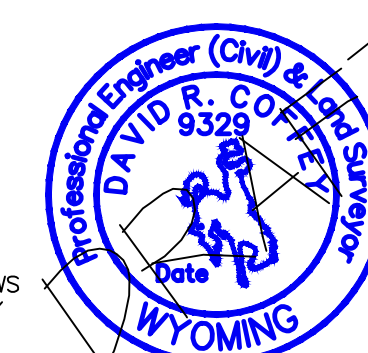

Project: 1764-04 ALLEY VAC.
Drawing: PA
Date: 06/15/21
Rev. Date:
Check By: DRG

VACATION MAP
ALLEY VACATION
McCUE ADDITION, LOTS 1-11, BLOCK ONE
ALBANY COUNTY, WYOMING

COFFEY
ENGINEERING & SURVEYING
900
IP 307.742.7425 | F 307.742.7403