

RENEWAL OF LIQUOR LICENSE OR PERMIT APPLICATION

(State of Wyoming-County and Municipal Jurisdictions)

FOR LIQUOR DIVISION USE ONLY			
Customer #:	D-70018		
1 st Reviewer:		/	/
2 nd Reviewer:		/	/

CLERK SECTION: Completed by City / Town / County Clerk		Local License # <u>BG-13</u>
Filing In Jurisdiction: <u>CITY OF LARAMIE</u>	Date filed with clerk: <u>2 / 12 / 26</u>	
Fees Annual License Fee: \$ <u>3000 .00</u>	Advertising Dates: (Minimum 2 Consecutive Weeks Prior to Hearing) <u>3 / 18 / 26 & 3 / 25 / 26</u>	
Publishing Fee: \$ <u>Billed by paper</u>	Public Hearing Date: <u>4 / 7 / 26</u>	
Publishing Fee Direct Billed to Applicant: <input type="checkbox"/>		
License Term: <u>5/8/2026</u> Through <u>5/7/2027</u>		

LICENSING AUTHORITY CLERK: BEGIN ADVERTISING PROMPTLY!
PER W.S. 12-4-104(d): IMMEDIATELY FORWARD A COPY OF THE APPLICATION AND ALL ATTACHEMENTS TO THE DIVISION. NO LICENSING AUTHORITY SHALL APPROVE OR DENY AN APPLICATION UNTIL THE LIQUOR DIVISION HAS CERTIFIED THE APPLICATION IS COMPLETE.

SECTION 1: APPLICANT & LOCATION INFORMATION

Applicant (Business Name): REGAL CINEMAS INC

Doing Business As (DBA) / Trade Name: REGAL CINEMAS FOX 6

Building to be licensed / Building Address: 505 SOUTH 20TH STREET
LARAMIE, WY 82070 ALBANY

Local Mailing Address: [REDACTED]

Business Telephone Number: [REDACTED] Fax Number: [REDACTED]

Business E-Mail Address: [REDACTED]

Business Primary Contact: Todd Biruff
 First Name Last Name

SECTION 2: FILING AS: CORPORATION (INC) Regal Cinemas Inc **SECTION 3: FILING FOR:** RENEWAL OF LICENSE OR PERMIT

SECTION 4: TYPE OF LICENSE OR PERMIT

(a) BAR & GRILL LIQUOR LICENSE

(i) Licenses and Permits Authorized for On-Premise Sales and Off-Premise Package Sales* (W.S. 12-6-101(c)(vi))

Primary Business Type (CHOOSE ONLY ONE)

ON-PREMISE: BAR | OFF-PREMISE: PACKAGE STORE | ON & OFF PREMISE: BAR & PACKAGE STORE

*APPLIES TO ONLY THE FOLLOWING: (RETAIL LIQUOR LICENSE, COUNTY MALT BEVERAGE PERMIT, MICROBREWERY OR WINERY PERMIT, WINERY SATELLITE, MANUFACTURER SATELLITE)

SECTION 5: SPECIAL STATUTORY DESIGNATIONS: NONE IF BLANK

Other:

SECTION 6: OPERATIONAL STATUS (W.S. 12-1-101(a)(xxi) / 12-2-301(c) / 12-4-103(a)(iv)) and to assist the Liquor Division with Scheduling Inspections)

SEASONAL MONTHS OF OPERATION: from Jan to Dec All Year (Jan-Dec)

NON-OPERATIONAL / PARKED DAYS OF WEEK OF OPERATION: from Sunday to Sat Every Day (Mon-Sun)

NON-OPERATIONAL START DATE: HOURS OF OPERATION: from 11:00am to 10pm 24 Hours a Day

ALL APPLICANTS MUST COMPLETE QUESTIONS 1- 3

1. BUILDING OWNERSHIP: W.S. 12-4-103(a)(iii)

Does the Applicant own or lease the licensed building?

(a) The Applicant **OWNS** the licensed building. YES (own)

(b) The Applicant **LEASES** the licensed building. YES (lease)

If the building is leased, attach a copy of the lease agreement and complete (i) through (iii) below:

(i) The lease term expiration date is: 02 / 28 / 2029; or, Does not expire / Automatically Renews.

Note: The lease term **MUST** continue at least through the term of the liquor license or permit.

(ii) The lease term information is located on page(s) Page 2 paragraph(s) Section 2 of Fourth Amendment to Management Agreement.

(iii) Sales provision for alcoholic or malt beverages: located, on page(s) Pages 1 & 2 paragraph(s) Section 3 of First Amendment (aka 3rd Amendment) to Management Agreement.

Note: The lease **MUST** contain a provision specifically allowing the **SALE OF ALCOHOLIC OR MALT BEVERAGES**.

(c) The lease is current and on file with the Licensing Authority. YES NO

(i) If NO to (c), attach a copy of the current lease agreement and complete 1.(b), (i) through (iii)

ALL APPLICANTS MUST COMPLETE QUESTIONS 2- 3

2. LIQUOR BUSINESS CONTROL: W.S. 12-4-601(b)

- (a) To operate the liquor business, has the business or license/permit been assigned, leased, transferred or contracted with any other person (entirely) to operate and assert total or partial control of the license or permit or the licensed building? YES NO
- (b) If the answer was YES to 2(a) above, attach a written explanation and copies of any documents in connection there within.

3. INTEREST IN LICENSE OR PERMIT: W.S. 12-5-401, 12-5-402, 12-5-403

Does any alcohol manufacturer, brewer, rectifier, wholesaler, or through a subsidiary affiliate, officer, director or member of any such firm:

- (a) Hold any interest in the license/permit applied for? YES NO
- (b) Furnish by way of loan or any other money or financial assistance for purposes hereof in the business? YES NO
- (c) Furnish, give, rent or loan any equipment, fixtures, interior decorations or signs other than standard brewery or manufacturer's signs? YES NO
- (d) If the answer was YES to any of the above questions, attach a written explanation and copies of any documents in connection there within.

QUESTIONS 4-16 AND SIGNATURE PAGE: COMPLETED BY THE APPLICANT AS APPLICABLE

4. RETAIL LIQUOR LICENSE-COMMERCIAL SERVICE AIRPORTS ONLY: W.S. 12-4-201(m)

- (a) Will food and beverage services be contracted or subcontracted? YES NO
- (i) If YES to (a), The contract or subcontract is current and on file with the Licensing Authority. YES NO
- (ii) If NO to (a) (i), attach a copy of the current contract or subcontract.

5. BAR AND GRILL LICENSE OR RESTAURANT LIQUOR LICENSE ONLY: 12-4-413(a) / W.S. 12-4-407(a)

Is a copy of the valid food service permit or the approved permit application attached? YES NO

6. RESTAURANT LIQUOR LICENSE: W.S. 12-4-407(a) / W.S. 12-4-408

- | | | | |
|---|------------------------|----------|------------|
| (a) Gross sales figures and percentages of income derived from: | (Line 1) Liquor Sales: | \$ _____ | (_____)% |
| | (Line 2) Food Sales: | \$ _____ | (_____)% |
| (Line 1 + Line 2 must = Line 3) | (Line 3) Gross Sales: | \$ _____ | (_____)% |

7. BAR AND GRILL LICENSE LIQUOR LICENSE: W.S. 12-4-413(a) / W.S. 12-4-413(h),(j),(k)

- | | | | |
|---|-------------------------------|---------------|----------|
| (a) Gross sales figures and percentages of income derived from: | (Line 1) Liquor Sales: | \$ [REDACTED] | (2)% |
| | (Line 2) Food Sales: | \$ [REDACTED] | (60)% |
| | (Line 3) Entertainment Sales: | \$ [REDACTED] | (38)% |
| (Line 1 + Line 2 + Line 3 must = Line 4) | (Line 4) Gross Sales: | \$ [REDACTED] | (100)% |

8. RESORT LIQUOR LICENSE: W.S. 12-4-401 through W.S. 12-4-405

Does the resort complex:

- (a) Have an actual valuation of at least one million dollars, or have committed or expended not less than one million dollars (\$1,000,000.00) on the complex, excluding the value of the land? W.S. 12-4-401(b)(i) YES NO
- (b) Include a restaurant and a convention facility; a convention facility that will seat at least one hundred (100) persons? W.S. 12-4-401(b)(ii) YES NO
- (c) Include motel, hotel or privately owned condominium, town house or home accommodations approved for short term occupancy with at least one hundred (100) sleeping rooms? W.S. 12-4-401(b)(iii) YES NO
- (d) If no on question (c), have a ski resort facility open to the general public in which has been committed or expended not less than 10 million dollars (\$10,000,000.00) on the facility? W.S. 12-4-401(b)(iv) YES NO
- (e) Will food and beverage services be contracted or subcontracted? W.S. 12-4-403(b) YES NO
- (i) If YES to (e), The contract or subcontract is current and on file with the Licensing Authority. YES NO

9. RESORT HOTEL LIQUOR LICENSE: W.S. 12-4-416 / W.S. 12-4-403 through W.S. 12-4-405

Does the resort hotel:

- (a) Have an actual valuation of at least five million dollars, or have committed or expended at least five million dollars (\$5,000,000.00) on the complex, including the value of the land? W.S. 12-4-416(b)(i) YES NO
- (b) Include a full-service restaurant? W.S. 12-4-416(b)(ii) YES NO
- (c) Include not less than twenty (20) sleeping rooms for short-term occupancy? W.S. 12-4-416(b)(iii) YES NO
- (d) Provide dining services to guest rooms for not less than twelve (12) hours each day? W.S. 12-4-416(b)(iv) YES NO
- (e) Provide facilities to accommodate business meetings for not less than fifty (50) participants? W.S. 12-4-416(b)(v) YES NO
- (f) Will food and beverage services be contracted or subcontracted? W.S. 12-4-403(b) YES NO
 - (i) If YES to (f), The contract or subcontract is current and on file with the Licensing Authority. YES NO
 - (ii) If NO to (f) (i), attach a copy of the current contract or subcontract.

10. MICROBREWERY PERMIT:

WHOLESALE DISTRIBUTION: W.S. 12-2-201(a)

- (a) Will or does the microbrewery at this location self-distribute its products or distribute through a licensed wholesaler? YES NO
- If YES to (a); contact the Wyoming Liquor Division for further information.

PRODUCTION REQUIREMENTS: W.S. 12-1-101(a)(xix)

- (b) **Malt Beverage Production**

Minimum barrel production required for the current license term: 50.00

 - (i) Barrels produced to date for the current license term: _____
 - (ii) Variance: _____
- (c) Will the microbrewery at this location have produced at least 50 barrels (1,550 gallons) but less than 50,000 barrels (1,550,000 gallons) by the end of the current license term as required by law? YES NO
- (i) If NO to (c), attach a written explanation.

11. LIMITED RETAIL (CLUB) LIQUOR LICENSE: FRATERNAL CLUBS W.S. 12-1-101(a)(III)(B)

- (a) Has the fraternal organization been actively operating in at least thirty-six (36) states? YES NO
- (b) Has the fraternal organization been actively in existence for at least twenty (20) years? YES NO

12. LIMITED RETAIL (CLUB) LIQUOR LICENSE: VETERANS CLUBS W.S. 12-1-101(a)(III)(A)

- (a) Does the Veteran's organization hold a charter by the Congress of the United States? YES NO
- (b) Is the membership of the Veteran's organization comprised only of Veterans and its duly organized auxiliary? YES NO

13. LIMITED RETAIL (CLUB) LIQUOR LICENSE: GOLF CLUBS W.S. 12-1-101(a)(III)(D) / W.S. 12-4-301(e)

- (a) Does the golf club have more than fifty (50) bona fide members? YES NO
- (b) Does the Applicant, maintain, or operate a bona fide golf course together with a clubhouse? YES NO
- (c) Is the Applicant a Political Subdivision of the state that owns, maintains, or operates this golf course? YES NO
 - (i) Will food and beverage services be contracted or subcontracted? W.S. 12-4-301(e) YES NO
 - (ii) If YES to (c) (i), The contract or subcontract is current and on file with the Licensing Authority. YES NO
 - (iii) If NO to (c) (i), attach a copy of the current contract or subcontract.

14. LIMITED RETAIL (CLUB) LIQUOR LICENSE: SOCIAL CLUBS W.S. 12-1-101(a)(III)(E) / W.S. 12-4-301(b)

- (a) Does the club have more than one hundred (100) bona fide members who are residents of the county in which the club is located? YES NO
- (b) Is the club incorporated and operating solely as a nonprofit organization under the laws of this state? YES NO
- (c) Is the club qualified as a tax-exempt organization under the Internal Revenue Service? YES NO
- (d) Has the club been in continuous operation for a period of not less than one (1) year? YES NO
- (e) Has the club received twenty-five dollars (\$25.00) from each bona fide member as recorded by the secretary of the club and are club members at the time of this application in good standing by having paid at least one (1) full year in dues? YES NO
- (f) Does the club hold quarterly meetings and have an actively engaged membership carrying out the objectives of the club? YES NO

15. For Applicants Filing As: Individual, General Partnership, Political Subdivision, Organization or Other: W.S. 12-4-102(a)(II) & (III)

Each individual, partner or officer (as applicable) listed below must complete all of the information below.

(If more information is required, list on a separate piece of paper and attach to this application.)

True and Correct Name	Date of Birth	Residence Address No. & Street City, State & Zip <i>DO NOT LIST PO BOXES</i>	Residence Phone Number	Have you been a DOMICILED resident for at least 1 year and not claimed residence in any other state in the last year?	Have you been convicted within the previous 10 years of:	
					Any Felony under Wyoming law?	Any Violation under Wyoming law relating to the sale or manufacture of Alcoholic Liquor or Malt Beverages?
				YES <input type="checkbox"/> NO <input type="checkbox"/>	YES <input type="checkbox"/> NO <input type="checkbox"/>	YES <input type="checkbox"/> NO <input type="checkbox"/>
				YES <input type="checkbox"/> NO <input type="checkbox"/>	YES <input type="checkbox"/> NO <input type="checkbox"/>	YES <input type="checkbox"/> NO <input type="checkbox"/>
				YES <input type="checkbox"/> NO <input type="checkbox"/>	YES <input type="checkbox"/> NO <input type="checkbox"/>	YES <input type="checkbox"/> NO <input type="checkbox"/>
				YES <input type="checkbox"/> NO <input type="checkbox"/>	YES <input type="checkbox"/> NO <input type="checkbox"/>	YES <input type="checkbox"/> NO <input type="checkbox"/>

16. For Applicants Filing As: Corporation (INC), Limited Company (LC), Limited Liability Company (LLC), Limited Liability Partnership (LLLP) or Limited Partnership (LP): W.S. 12-4-102(a)(iv) & (v)

(a) Is the Applicant Registered and Active with the Wyoming Secretary of State as required per YES NO NOT APPLICABLE W.S. 12-4-103(a)(x) or as otherwise required by Wyoming state laws?

List below: Each Officer, Director, stockholder, legal entity or member holding, either jointly or severally, ten percent (10%) or more of the outstanding and issued capital stock or ownership of the corporation, limited liability company, limited liability partnership, or limited partnership.

Each Officer, Director or LLC member listed below must complete all of the information below.

(If more information is required, list on a separate piece of paper and attach to this application.)

True and Correct Name	Date of Birth	Residence Address No. & Street City, State & Zip <i>DO NOT LIST PO BOXES</i>	Residence Phone Number	No. of Years In Corp or LLC	% of Corporate Stock or Ownership Held	Have you been convicted within the previous 10 years of:	
						Any Felony under Wyoming law?	Any Violation under Wyoming law relating to the sale or manufacture to Alcoholic Liquor or Malt Beverages?
Regal Cinemas, Inc.					100%	YES <input type="checkbox"/> NO <input checked="" type="checkbox"/>	YES <input type="checkbox"/> NO <input checked="" type="checkbox"/>
Todd Buruff				2 years	0%	YES <input type="checkbox"/> NO <input checked="" type="checkbox"/>	YES <input type="checkbox"/> NO <input checked="" type="checkbox"/>
John Curry				2 years	0%	YES <input type="checkbox"/> NO <input checked="" type="checkbox"/>	YES <input type="checkbox"/> NO <input checked="" type="checkbox"/>
						YES <input type="checkbox"/> NO <input type="checkbox"/>	YES <input type="checkbox"/> NO <input type="checkbox"/>

REQUIRED ATTACHMENTS:

- A copy of any new or updated lease agreement(s) if not currently on file with the Licensing Authority. W.S. 12-4-103(a)(iii)
- Bar & Grill and Restaurant liquor license Applicants: Attach a copy of the current Food Service Permit or the approved permit application for the Applicant and for the licensed building location. 12-4-413(a) / W.S. 12-4-407(a)
- If food and beverage services will be contracted or subcontracted attach a copy of the contract or lease agreement if the agreement on file with the Licensing Authority is not current. W.S. 12-4-201(m) / W.S. 12-4-301(a) / W.S. 12-4-403(b)

OATH OR VERIFICATION W.S. 12-4-102(b)

Requires signatures by:

ALL individuals, ALL Partners, ONE (1) LLC Member, or TWO (2) Corporate Officers or Directors except that if all the stock of the corporation is owned by ONE (1) individual then that individual may sign and verify the application upon his oath, or ONE (1) Officer or Director, or Member of an Organization or Association.

Any individual who signs the application must also be listed on Question 15 or Question 16 as applicable or additional documentation must be provided confirming legal authority to sign the application on behalf of the Applicant.

Under penalty of perjury, and the possible revocation or cancellation of the license, I swear the above stated facts, are true and accurate.

STATE OF ~~KNOX~~ TENNESSEE)
COUNTY OF KNOX) SS.

Signed and sworn to before me on this 4th day of February, 2026 that the facts alleged in the foregoing instrument are true by the following:

1) <u>[Signature]</u> (Signature)	Todd Boruff (Printed Name)	President & Asst Secretary Title
2) <u>[Signature]</u> (Signature)	John Curry (Printed Name)	Vice President & SecTreasurer Title
3) _____ (Signature)	_____ (Printed Name)	_____ Title
4) _____ (Signature)	_____ (Printed Name)	_____ Title
5) _____ (Signature)	_____ (Printed Name)	_____ Title

Witness my hand and official seal:

[Signature]
Signature of Notary Public

SEAL)



My commission expires: 4-11-2029

ANNUAL ALCOHOL SERVER TRAINING REPORT

Alcohol Server Training is Required for: LMC 5.09.060.G. Each licensee and all managers, supervisory personnel, and all persons who will be selling, serving or managing the sale of alcoholic beverages employed at the licensed premises shall complete an alcohol server training program certified by the Wyoming liquor division within 90 days of employment. Licensees shall maintain, upon the premises, a current list of applicable employees/participants with their date of hire/service, dates of orientation training and successful completion of the division's approved training program including any required continuing training. The list shall be available for inspection by the City Clerk or City Manager's designee within a reasonable time period. Upon application for liquor license or renewal of a liquor license, a license holder shall submit an annual report to the city clerk on completion orientation training or of an alcohol server training program by the licensee or persons who will be selling, serving or managing the sale of alcoholic beverages.

Name	Position in the company (Owner, Manager, Supervisor, or Server)	Alcohol Server Training or Orientation (Note which kind of training completed.)
Miranda Ware	General Manager	TIPS
Michelle Morimoto	Deputy General Manager	TIPS
Kathryn Salmons-Midaett	Assistant Manager	TIPS
Alexandria Matthews	Assistant Manager	TIPS
Brady Trujillo	Assistant Manager	TIPS
Genesis Burgess	Server	TIPS
Jack Kelsey	Server	TIPS
Melanie O'Connell	Server	TIPS

I attest that the above information is true and complete for Regal Cinema
(Business Name)

Miranda 2/1/24
(Date)
 (Signature of Owner/Manager)

811655 Mailed 6/11/25

Issued by:

**WYOMING DEPARTMENT OF AGRICULTURE
CONSUMER HEALTH SERVICES
2219 CAREY AVE
CHEYENNE, WY 82002
EQUAL OPPORTUNITY IN EMPLOYMENT AND SERVICES**

Retail Food

ACCOUNT # 3128

Whereas this party has made application for the licenses listed below in the State of Wyoming according to the law and agrees to comply with all laws, rules and regulations thereto, including the payment of all required fees, there is hereby issued to the applicant this license. This license is not transferable and, unless revoked, shall expire on the date indicated below.

Issued to:

REGAL CINEMAS, INC.
505 S 20TH ST
LARAMIE, WY 82070

EXPIRATION DATE:
7/12/2026

REGAL CINEMAS, INC.
ATTN: LISA BLANC
101 E BLOUNT AVE
KNOXVILLE, TN 37920

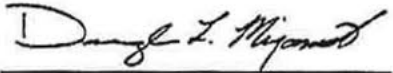

Director of Dept. of Ag

**THIS LICENSE MUST BE CURRENT
AND POSTED CONSPICUOUSLY
AT THE PHYSICAL LOCATION**

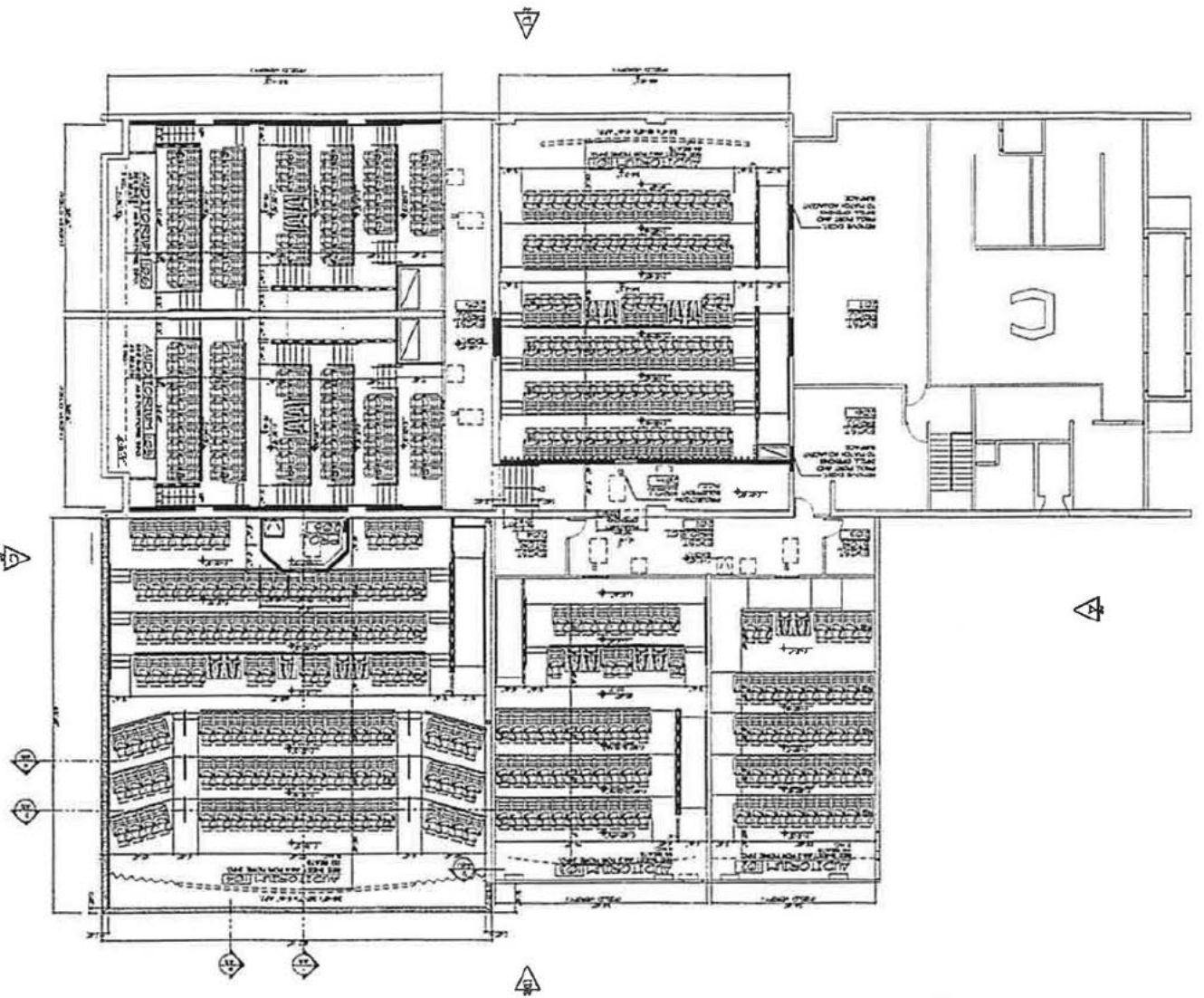

STUBEL AND ASSOCIATES
 413 BOON AVENUE
 CHELSEA, MASSACHUSETTS
 TEL: 278-1234 / FAX: 278-5678

WALLACE THURTELL MANAGEMENT COMPANY
 LUXURY REALTY SERVICES
 LARAMIE, WYOMING

BUILDING PLAN - UPPER LEVEL

1. ROOM LAYOUT SHALL INCLUDE SEE THE FOLLOWING:
 2. ROOM NO. 101
 3. ROOM NO. 102
 4. ROOM NO. 103
 5. ROOM NO. 104
 6. ROOM NO. 105
 7. ROOM NO. 106
 8. ROOM NO. 107
 9. ROOM NO. 108
 10. ROOM NO. 109
 11. ROOM NO. 110
 12. ROOM NO. 111
 13. ROOM NO. 112
 14. ROOM NO. 113
 15. ROOM NO. 114
 16. ROOM NO. 115
 17. ROOM NO. 116
 18. ROOM NO. 117
 19. ROOM NO. 118
 20. ROOM NO. 119
 21. ROOM NO. 120
 22. ROOM NO. 121
 23. ROOM NO. 122
 24. ROOM NO. 123
 25. ROOM NO. 124
 26. ROOM NO. 125
 27. ROOM NO. 126
 28. ROOM NO. 127
 29. ROOM NO. 128
 30. ROOM NO. 129
 31. ROOM NO. 130
 32. ROOM NO. 131
 33. ROOM NO. 132
 34. ROOM NO. 133
 35. ROOM NO. 134
 36. ROOM NO. 135
 37. ROOM NO. 136
 38. ROOM NO. 137
 39. ROOM NO. 138
 40. ROOM NO. 139
 41. ROOM NO. 140
 42. ROOM NO. 141
 43. ROOM NO. 142
 44. ROOM NO. 143
 45. ROOM NO. 144
 46. ROOM NO. 145
 47. ROOM NO. 146
 48. ROOM NO. 147
 49. ROOM NO. 148
 50. ROOM NO. 149
 51. ROOM NO. 150
 52. ROOM NO. 151
 53. ROOM NO. 152
 54. ROOM NO. 153
 55. ROOM NO. 154
 56. ROOM NO. 155
 57. ROOM NO. 156
 58. ROOM NO. 157
 59. ROOM NO. 158
 60. ROOM NO. 159
 61. ROOM NO. 160
 62. ROOM NO. 161
 63. ROOM NO. 162
 64. ROOM NO. 163
 65. ROOM NO. 164
 66. ROOM NO. 165
 67. ROOM NO. 166
 68. ROOM NO. 167
 69. ROOM NO. 168
 70. ROOM NO. 169
 71. ROOM NO. 170
 72. ROOM NO. 171
 73. ROOM NO. 172
 74. ROOM NO. 173
 75. ROOM NO. 174
 76. ROOM NO. 175
 77. ROOM NO. 176
 78. ROOM NO. 177
 79. ROOM NO. 178
 80. ROOM NO. 179
 81. ROOM NO. 180
 82. ROOM NO. 181
 83. ROOM NO. 182
 84. ROOM NO. 183
 85. ROOM NO. 184
 86. ROOM NO. 185
 87. ROOM NO. 186
 88. ROOM NO. 187
 89. ROOM NO. 188
 90. ROOM NO. 189
 91. ROOM NO. 190
 92. ROOM NO. 191
 93. ROOM NO. 192
 94. ROOM NO. 193
 95. ROOM NO. 194
 96. ROOM NO. 195
 97. ROOM NO. 196
 98. ROOM NO. 197
 99. ROOM NO. 198
 100. ROOM NO. 199
 101. ROOM NO. 200

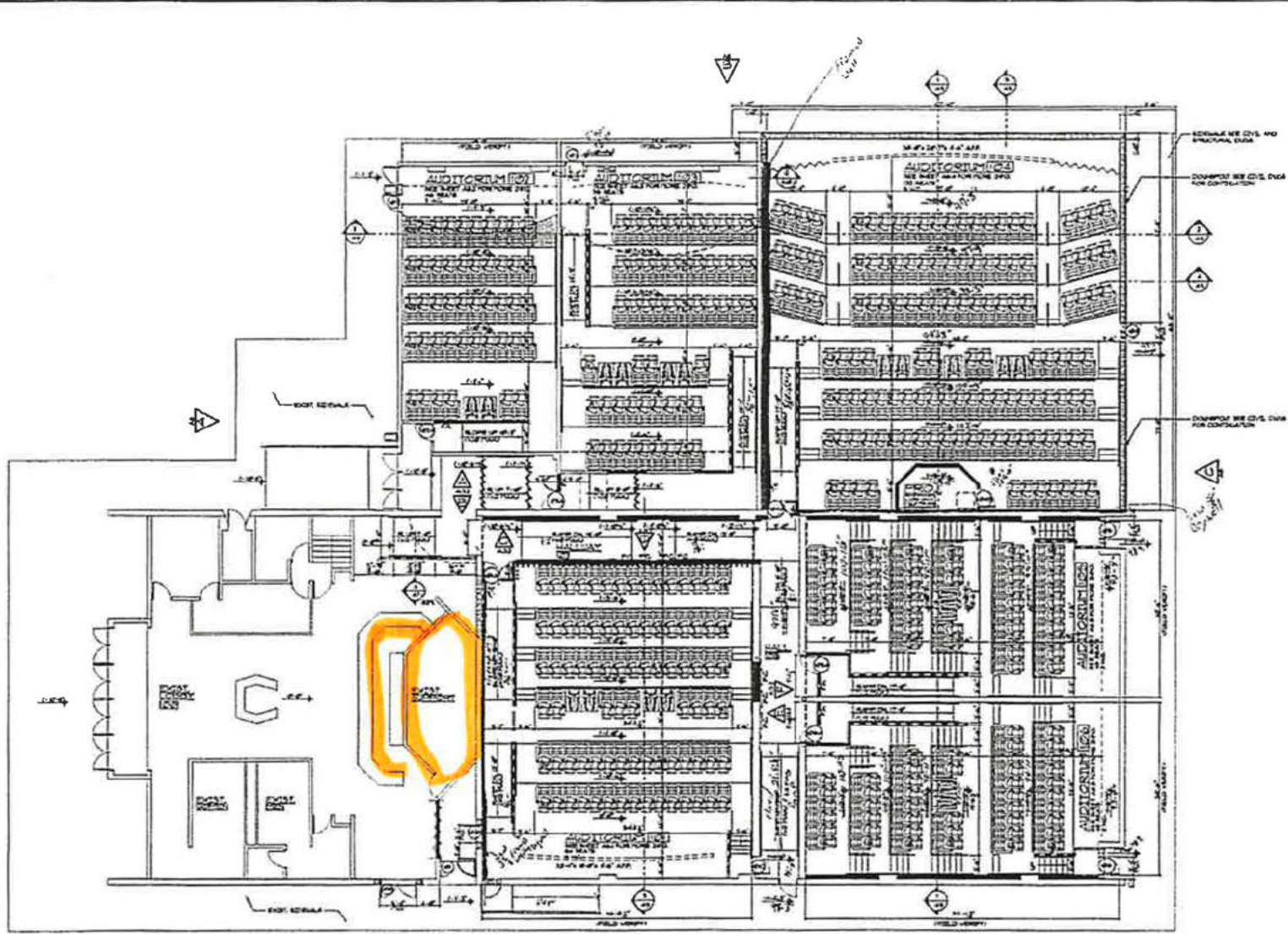

FLOOR PLAN NOTES

1. FOR LARGING SCALE DRAWINGS SEE THE FOLLOWING:
 - AUDITORIUM 101 SHEET 101-1
 - AUDITORIUM 102 SHEET 102-1
 - AUDITORIUM 103 SHEET 103-1
 - AUDITORIUM 104 SHEET 104-1
 - AUDITORIUM 105 SHEET 105-1
2. STRUCTURE PROVIDES TO-HIGH CLASS B CONCRETE WITH CLASS B REINFORCING. CHAIRS, HANGING PLATE WALL CONNECTIONS, CLIMB, ETC. SHALL BE CONFORMED PER APPROVED CODE. ALMOST FLUTE SPEED CLASSIFICATION TO ALL-DIG DEPARTMENT AND FOR PERMIT FOR APPROVAL.
3. PROVIDE ACCESSIBILITY COMPLIANCE PER APPROVED CODE. PROVIDE 5% SLOPE AND 2% OF WIDTH (MIN. 36" AND ALL LATER ACCESSIBILITY CODE REQUIREMENTS).
4. PROVIDE CONTRACTS WITH KING AT ALL PLAN LOCATIONS WITH ACCESSIBILITY.
5. IN AUDITORIUMS 101 AND 102, INSTALL 7" BLACK DUCT LINER ON FRONT OF IN-RISE AUDITORIUM WALLS EXCEPT WHERE WALL CHASE IS NOTED AND INSTALL 7" BLACK DUCT LINER ON SIDE AUDITORIUM WALLS. 7" AIR PURIFIER FOR WALLS EXCEPT WHERE WALL CHASE IS NOTED. ALL CHAIRS, REINFORCING AND FLOOR CONNECTIONS SHALL BE FIELD TO ACCEPTED PRACTICE. LINER AND CHAIRS SHALL BE FIELD TO ACCEPTED PRACTICE.
6. IN AUDITORIUMS 103 AND 104, INSTALL 7" BLACK DUCT LINER ON FRONT OF IN-RISE AUDITORIUM WALLS EXCEPT WHERE WALL CHASE IS NOTED AND INSTALL 7" BLACK DUCT LINER ON SIDE AUDITORIUM WALLS. 7" AIR PURIFIER FOR WALLS EXCEPT WHERE WALL CHASE IS NOTED. ALL CHAIRS, REINFORCING AND FLOOR CONNECTIONS SHALL BE FIELD TO ACCEPTED PRACTICE. LINER AND CHAIRS SHALL BE FIELD TO ACCEPTED PRACTICE.
7. SEATING CHAIRS NUMBERED AND CHAIRS INSTALLED CONTRACTOR RESPONSIBLE FOR COORDINATION AND AS NOTED IN SPECIFICATIONS.
8. CONTRACTOR RESPONSIBLE FOR REMOVAL OF ALL EXISTING CONCRETE, REINFORCING, CHAIRS AND FORMS OF WALL, EXCEPT WHERE CHAIRS NUMBERED THEREAFTER AND FIELD PRODUCTION AND FIELD PRODUCTION IS TO BE PLACED ON 20" MIN. 18" CONC. BY OWNER.
9. ALL REINFORCING IS THROUGH THE REINFORCING IN THROUGH THE PRODUCTION LEVEL. FLOOR SLAB SHALL BE FIELD TO ACCEPTED PRACTICE FOR THE FIELD CONNECTIONS REQUIRED.

IN PLAN PLAN NOTES

1. VERIFY EXISTING CONDITIONS AND REPORT ANY DISCREPANCIES TO THE ARCHITECT PRIOR TO ANY FIELD CONNECTION.
2. ALL CONCRETE SHALL BE 4000 PSI (MIN. OVERLAP) WITH 4% REINFORCING. REINFORCING SHALL BE FIELD TO ACCEPTED PRACTICE FOR THE FIELD CONNECTIONS REQUIRED.
3. FOUR CONCRETE SLAB SHALL BE INSTALLED PARALLEL.
4. SEE STRUCTURAL DRAWINGS FOR INFORMATION ON REINFORCING.

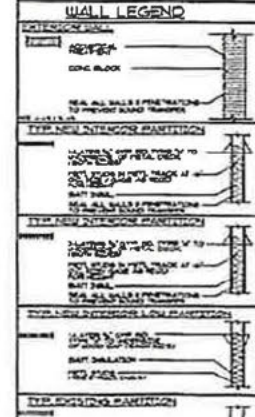

WALLACE THEATER MANAGEMENT COMPANY
 FOX THEATER
 LUXURY SEATING STADIUM RETRO-FIT
 LARCHMIE, ARIZONA
 4750 N. 19TH AVENUE, SUITE 100
 DENVER, CO 80202
 303-733-8377 / 703-531-0608 FAX
 27 MAR. 2019

