

Costs as described in the Petition forwarded to WYDOT.

TOTAL ESTIMATED QUANTITIES

ITEM NO	ITEM	UNIT	QUANTITY	COST	TOTAL
109.08000	MOBILIZATION	LS	LUMP SUM	\$25,000.00	\$25,000.00
503.01000	BRIDGE RAIL	FT	700	\$93.97	\$65,779.00
503.01400	PEDESTRIAN RAIL 42in	FT	700	\$191.70	\$134,190.00
503.01400	PEDESTRIAN RAIL 84in	FT	1,100	\$191.70	\$210,870.00
506.01024	DRILLED SHAFT FOUNDATIONS 24 in	FT	565	\$312.99	\$176,839.35
513.00020	CLASS B CONCRETE	LS	LUMP SUM	\$125,000.00	\$125,000.00
	ADJUST ROADWAY LIGHTING	EA	1	\$15,000.00	\$15,000.00
703.03110	TEMPORARY TRAFFIC CONTROL	LS	LUMP SUM	\$50,000.00	\$50,000.00

Total                      \$802,678.35  
 \$802,678.35

Unit prices were taken from the existing UPRR Overpass contract when possible.



SCALE: 1' = 150'

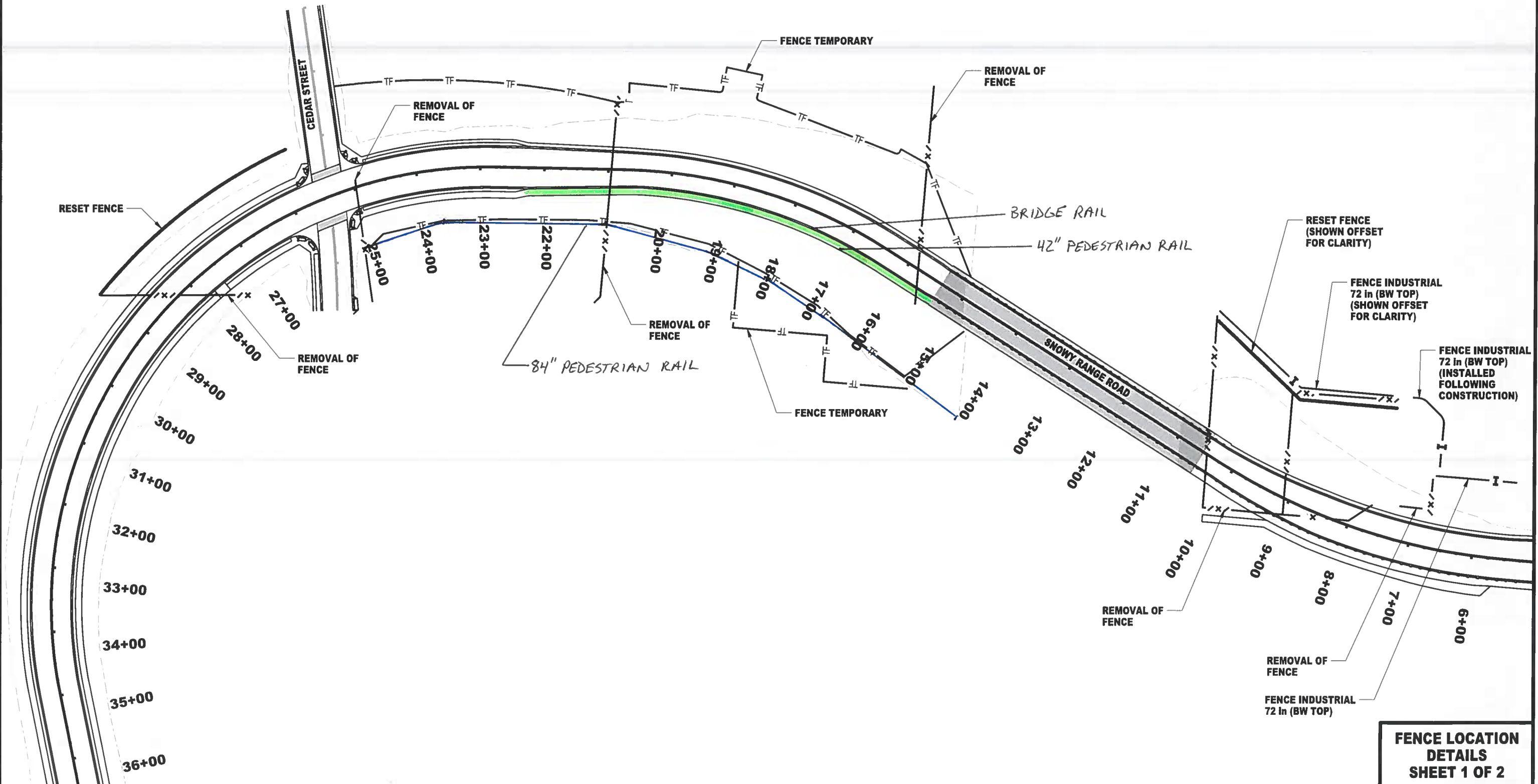

**FENCE LOCATION  
DETAILS  
SHEET 1 OF 2**